



PROJECT STATISTICS

PROJECT DESCRIPTION	
Location:	200 Charlton Ave. E
O.B.C. Classifications:	
Part	Div. B Part 9
Major Occupancy	Group C (Residential)
Zone	DE-3/5-970

FLOOR AREA RATIO	Permitted	Existing Building	Proposed Building	Combined
%	90%	95%	31%	126%
m2	4555	4800	1574	6374

SETBACKS	Req.	Existing (to building face)	Proposed (to building face)
Front Yard (south)		4.5	N/A
Side Yard (West)		8.5 & 1.9	6.6
Side Yard (East)		8.5	N/A
Rear Yard (North)		6.0	6.8

LOT	Req. Min.	Proposed
Lot Area (m2)	630.00	5061.00
Lot Width (m)	21.00	52.80
% Landscaped Area of Lot	25.0%	34.2%
Distance between buildings (m)	8m (1/2 the height of the taller)	20.10

FLOOR AREAS & BUILDING DATA	ft2	m2
Existing Building Dwelling Unit Count = 51		
Existing Building Total GFA	51,667	4800.00
Proposed Building Dwelling Unit Count = 17		
Proposed Building Area (for complete breakdown, see additional GFA table, this page)		
Parking Level GFA	131	12.17
Ground Floor GFA	5,500	510.94
2nd Floor GFA	5,500	510.94
3rd Floor GFA	5,355	497.53
Terrace	452	41.98
Total Proposed GFA	16,938	1573.57

HEIGHT	Permitted	Existing (m)	Proposed (m)
Heights	4 storeys (11m)	4 Storeys	4 Storeys (10.2m) to Terrace

PARKING & LOADING	Required	Proposed (inclusive of 2 barrier free)
Resident Spaces (0.8 per 68 total dwelling units)	55	43
Visitor Spaces (0.16 spaces per 68 total dwelling units)	11	0
Loading	1	1

GFA of New Building (elevator shafts, elevator vestibules, mech rooms and garbage rooms excluded ...)		
Name	Area (sqm)	Area (sqft)
Parking Level		
Stairwell A	12.17 m ²	131 ft ²
	12.17 m ²	131 ft ²
Ground Floor		
101	65.98 m ²	710 ft ²
102	64.80 m ²	698 ft ²
103	64.89 m ²	698 ft ²
104	68.13 m ²	733 ft ²
105	68.06 m ²	733 ft ²
106	68.06 m ²	733 ft ²
107	70.41 m ²	758 ft ²
Residents' Storage	17.42 m ²	187 ft ²
Stairwell A	12.17 m ²	131 ft ²
Stairwell B	11.03 m ²	119 ft ²
	510.94 m ²	5,500 ft ²

GFA of New Building (elevator shafts, elevator vestibules, mech rooms and garbage rooms excluded ...)		
Name	Area (sqm)	Area (sqft)
2nd Floor		
104 (2nd Flr)	68.13 m ²	733 ft ²
105 (2nd Flr)	68.06 m ²	733 ft ²
106 (2nd Flr)	68.06 m ²	733 ft ²
107 (2nd Flr)	70.41 m ²	758 ft ²
201	65.98 m ²	710 ft ²
202	64.80 m ²	698 ft ²
203	64.89 m ²	698 ft ²
Residents' Storage	17.42 m ²	187 ft ²
Stairwell A	12.17 m ²	131 ft ²
Stairwell B	11.03 m ²	119 ft ²
	510.94 m ²	5,500 ft ²

GFA of New Building (elevator shafts, elevator vestibules, mech rooms and garbage rooms excluded ...)		
Name	Area (sqm)	Area (sqft)
3rd Floor		
301	65.98 m ²	710 ft ²
302	64.80 m ²	698 ft ²
303	64.80 m ²	698 ft ²
304	64.80 m ²	698 ft ²
305	64.80 m ²	698 ft ²
306	64.80 m ²	698 ft ²
307	66.24 m ²	720 ft ²
Residents' Storage	17.42 m ²	187 ft ²
Stairwell A	12.17 m ²	131 ft ²
Stairwell B	11.03 m ²	119 ft ²
	497.53 m ²	5,355 ft ²
Terrace		
Residents' Storage	17.42 m ²	187 ft ²
Stairwell A	12.17 m ²	131 ft ²
Stairwell B	12.39 m ²	133 ft ²
	41.98 m ²	452 ft ²
Total GFA of New Building	1,573.57 m²	16,938 ft²

Revisions:

No.	Date:	Particular:	By:
1	2021.04.07	Clearer Graphics on Site Plan	ND

Date:	Particular:	By:
2019.06.20	CONCEPTUAL SITE PLAN	ND
2019.09.11	CONCEPTUAL SITE PLAN	ND
2019.09.16	CIVIL COORDINATION	ND
2019.09.18	ZONING AMENDMENT (REVIEW)	ND
2021.04.19	ZONING AMENDMENT SUBMISSION	ND

Drawings and specifications as instruments of service are the property of Romanov Romanov Architects Inc., the copyright in the same being reserved to them. No reproduction may be made without the permission of Romanov Romanov Architects Inc., and when made, must bear its name. All prints to be returned. This drawing must not be scaled. The contractor is to verify dimensions and data noted herein with conditions on the site and is held responsible for reporting any discrepancy to Romanov Romanov Architects Inc., for adjustment. This drawing is not to be used for building purpose until signed and sealed by the Consultant.



375 PARKSIDE DRIVE, TORONTO, ONTARIO, CANADA
M6R 2Z6, tel: (416) 766-8750, fax: (416) 766-8760

Project: **Corktown Co-Op**
Hamilton, ON

Sheet Title: **Site Plan & Statistics**

Design: JR	Drawn: ND	Approved: JR
-------------------	------------------	---------------------

Comm. No:	Sheet No:
09.122	A0.00

KNOWN AS **CHARLTON AVENUE**
(GEORGE STREET BY REGISTERED PLAN 1436)

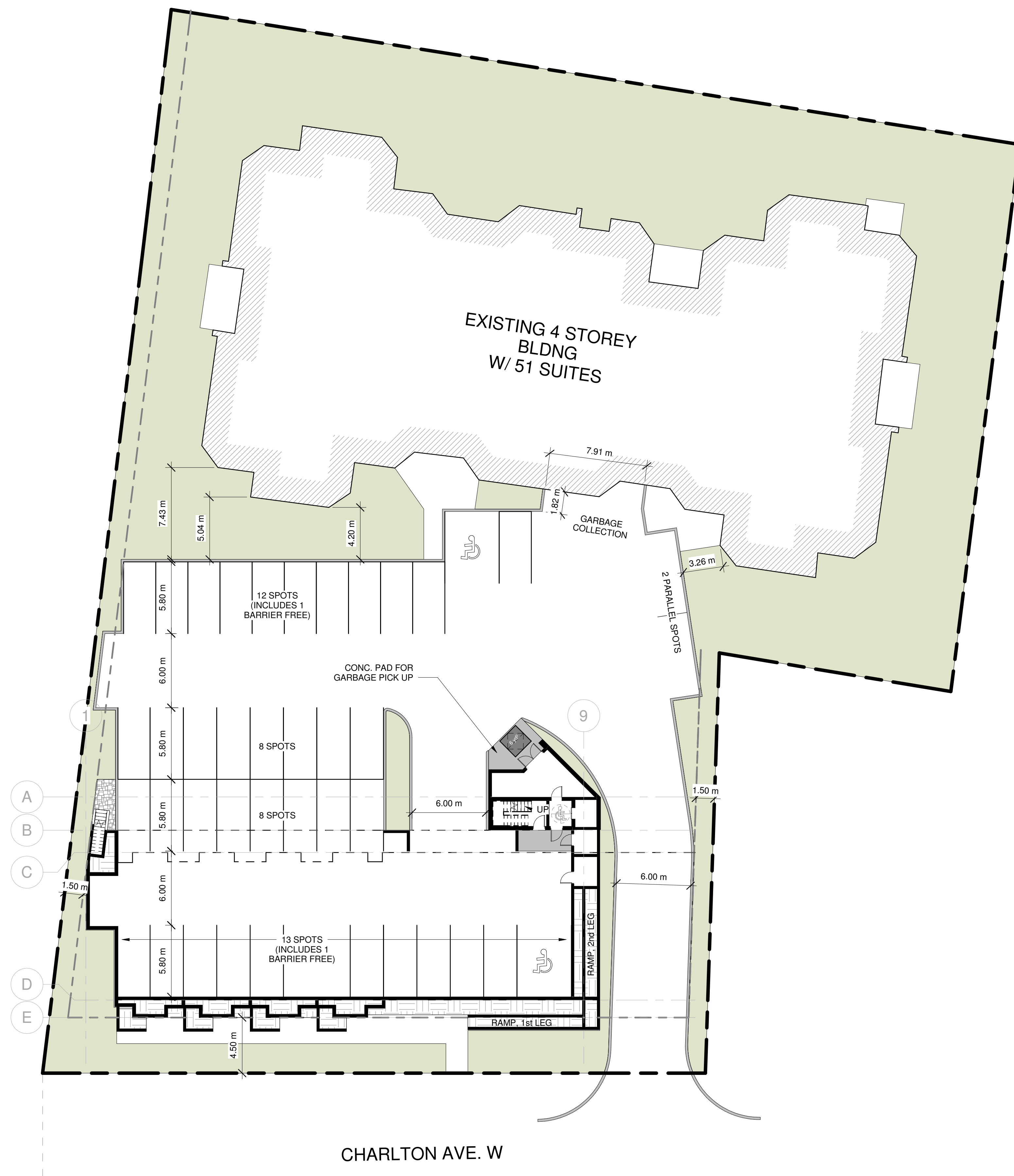

Revisions:

No.	Date:	Particular:	By:

Drawing Issue:

Date:	Particular:	By:
2021.04.19	ZONING AMENDMENT SUBMISSION	ND

Drawings and specifications as instruments of service are the property of Romanov Romanov Architects Inc., the copyright in the same being reserved to them. No reproduction may be made without the permission of Romanov Romanov Architects Inc., and when made, must bear its name. All prints to be returned. This drawing must not be scaled.

The contractor is to verify dimensions and data noted herein with conditions on the site and is held responsible for reporting any discrepancy to Romanov Romanov Architects Inc., for adjustment. This drawing is not to be used for building purpose until signed and sealed by the Consultant.



Project:
Corktown Co-Op
Hamilton, ON

Sheet Title:
Site Plan - Parking Visible

Design: JR	Drawn: ND	Approved: JR
---------------	--------------	-----------------

Comm. No: 09.122	Sheet No: A0.01
---------------------	--------------------

1 Site Plan - Parking Visible
1 : 200