

BENCH MARK NOTE:

ELEVATIONS ARE BASED ON GPS OBSERVATIONS FROM PERMANENT REFERENCE STATIONS IN THE NAD83 (CSRS-2010) COORDINATE SYSTEM, WITH HEIGHTS CONVERTED TO ORTHOMETRIC ELEVATIONS ON THE CGVD28 DATUM (1978 ADJUSTMENT) WITH GEOID MODEL HTV2.0, AS SUPPLIED BY NATURAL RESOURCES CANADA.

ELEVATIONS HAVE BEEN ADJUSTED TO MATCH CITY OF HAMILTON BENCHMARK MONUMENT No. 07720100045 & No. 07720100046.

SITE BENCHMARK #1: BASED ON CUT CROSS IN SIDEWALK AT THE SOUTHWEST CORNER OF SUBJECT PROPERTY HAVING AN ELEVATION OF 85.30 METRES.

SITE BENCHMARK #2: BASED ON CUT CROSS IN SIDEWALK NEAR THE NORTHEAST LIMIT OF SUBJECT PROPERTY HAVING AN ELEVATION OF 84.65 METRES.

1 4 3 3

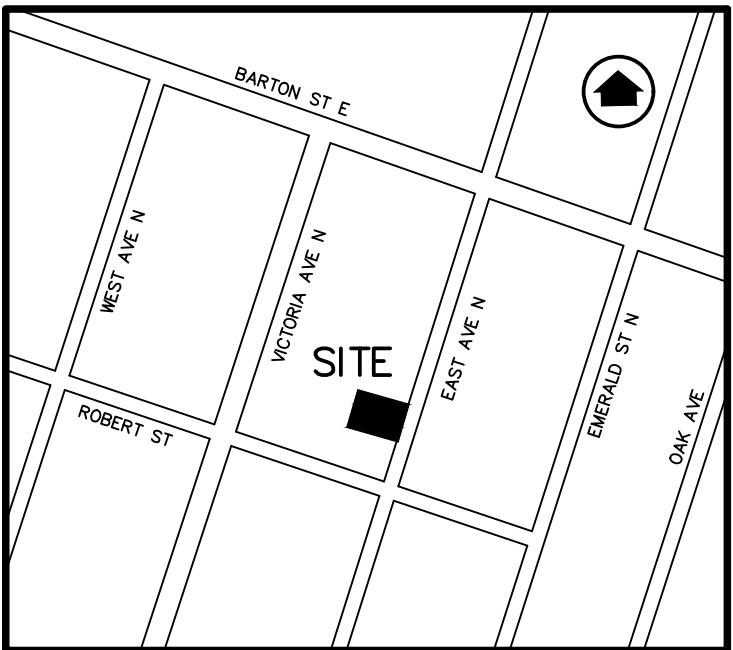
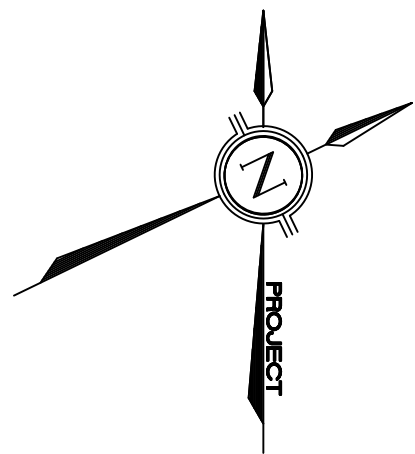

LEGEND:

- EXISTING GROUND ELEVATION
- PROPOSED GROUND ELEVATION
- PROPOSED ELEVATION TO MATCH EXISTING
- PROPOSED SWALE ELEVATION
- PROPOSED TOP OF WALL ELEVATION
- PROPOSED BOTTOM OF WALL ELEVATION
- EXISTING CATCHBASIN
- EXISTING STORM/SANITARY MANHOLE
- PROPOSED DIRECTION OF SHEET FLOW
- PROPOSED CATCHBASIN
- PROPOSED STORM/SANITARY MANHOLE
- PROPOSED CATCHBASIN MANHOLE
- PROPOSED SILTATION CONTROL FENCE
- PROPOSED CATCHBASIN SILT SACK
- EMERGENCY OVERLAND FLOW ROUTE
- PROPOSED DRAINAGE BREAK LINE
- EXISTING DIRECTION OF SHEET FLOW

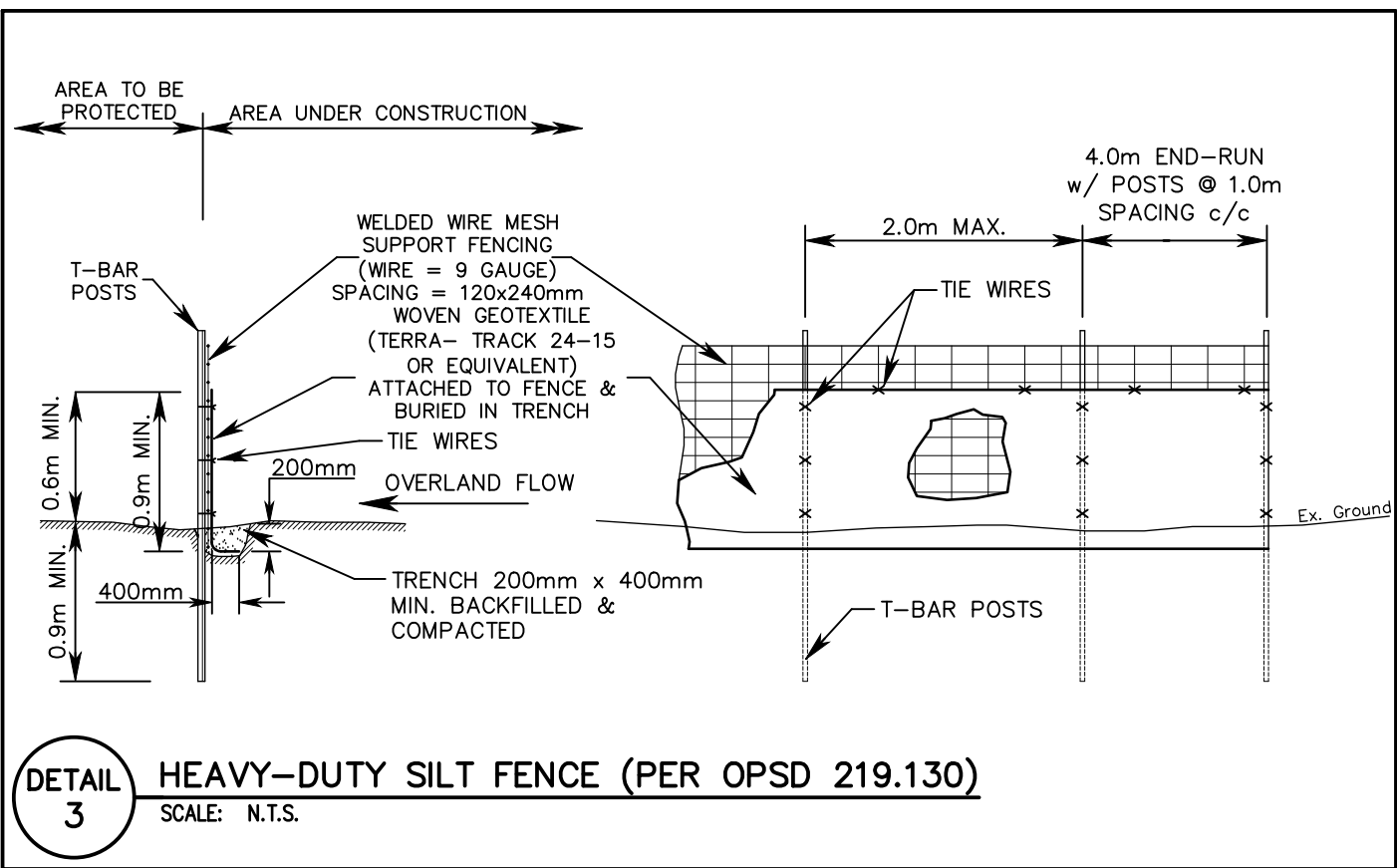

NOTES TO CONTRACTOR:

- INSPECTION**
CONTRACTOR IS RESPONSIBLE FOR CONTACTING ENGINEER 48 HRS PRIOR TO COMMENCING WORK TO ARRANGE FOR INSPECTION. ENGINEER TO DETERMINE DEGREE OF INSPECTION AND TESTING REQUIRED FOR CERTIFICATION OF UNDERGROUND SERVICE INSTALLATION AS MANDATED BY ONTARIO BUILDING CODE DIVISION C, PART 1, SECTION 1.2.2, GENERAL REVIEW. FAILURE TO NOTIFY ENGINEER WILL RESULT IN EXTENSIVE POST CONSTRUCTION INSPECTION AT CONTRACTORS EXPENSE.
- CONFIRMATION OF EXISTING INVERTS**
72 HOURS PRIOR TO THE START OF CONSTRUCTION, THE CONTRACTOR IS TO LOCATE, EXPOSE AND VERIFY INVERTS OF EXISTING SEWERS AT CONNECTION POINTS. SHOULD THE CONTRACTOR PROCEED WITHOUT COMPLETING THESE LOCATES, EXTRA COSTS RESULTING FROM DELAYS AND STANDBY TIME WILL NOT BE CONSIDERED.

BEARING AND COORDINATE NOTE:

- BEARINGS ARE GRID BEARINGS AND ARE DERIVED FROM GPS OBSERVATIONS AND ARE REFERRED TO THE UTM PROJECTION, ZONE 17, NAD 83 (CSRS-2010) ADJUSTMENT.
- DISTANCES SHOWN ON THIS PLAN ARE ADJUSTED GRID DISTANCES AND CAN BE CONVERTED TO GRID DISTANCES BY MULTIPLYING BY AN AVERAGED COMBINED SCALE FACTOR OF 0.999699.
- COORDINATES ON THIS PLAN ARE UTM, ZONE 17, NAD83 (CSRS-2010) ADJUSTMENT AND ARE BASED ON GPS OBSERVATIONS FROM A NETWORK OF PERMANENT GPS REFERENCE STATIONS.

NOTES TO CONTRACTOR:

- CONTRACTORS AND SUBCONTRACTORS SHALL NOT SCALE FROM THIS DRAWING.
- ANY INCONSISTENCIES AND OMISSIONS FOUND ON THE DRAWINGS MUST BE REPORTED TO THE ENGINEER FOR CLARIFICATION BEFORE COMMENCING THE WORK.
- PRIOR TO THE START OF CONSTRUCTION, THE CONTRACTOR MUST CHECK AND VERIFY ALL DIMENSIONS AND ELEVATIONS AND REPORT ALL FINDINGS TO THE ENGINEER. ONCE CONSTRUCTION HAS COMMENCED, THE CONTRACTOR ACCEPTS RESPONSIBILITY FOR ALL DIMENSIONS, ELEVATIONS, AND SITE CONDITIONS.
- THE POSITIONS OF POLE LINES, CONDUITS, WATERMANS, SEWERS AND OTHER UNDERGROUND AND OVER-GROUND UTILITIES AND STRUCTURES ARE NOT NECESSARILY SHOWN ON THE DRAWINGS. WHERE SHOWN ON THE DRAWING, THE ACCURACY OF THE POSITION OF SUCH UTILITIES AND STRUCTURES IS NOT GUARANTEED. BEFORE STARTING WORK, THE CONTRACTOR SHALL INFORM THEMSELVES OF THE EXACT LOCATION OF ALL SUCH UTILITIES AND STRUCTURES AND ASSUME ALL LIABILITY FOR DAMAGE TO THEM.
- ALL DRAWINGS REMAIN THE PROPERTY OF THE ENGINEER AND SHALL NOT BE REPRODUCED, REUSED, OR REVISED WITHOUT THE WRITTEN CONSENT OF S. LLEWELLYN AND ASSOCIATES LIMITED.

*PAVEMENT STRUCTURES ARE AS PER GEOTECHNICAL REPORT PREPARED MARCH 24, 2020 BY PTO MACCALLUM LTD

PAVEMENT STRUCTURE

LAYER	LIGHT DUTY ASPHALT	HEAVY DUTY ASPHALT	CONCRETE	CONCRETE SIDEWALK
HL3	40mm	40mm	—	—
HLB	40mm	60mm	—	—
CONCRETE	—	—	200mm	150mm
GRANULAR A	150mm	150mm	200mm	150mm
GRANULAR B	250mm	300mm	—	—

14	JUNE 7, 2021	SJD	AS PER REVISED SITE PLAN (PHASE 3)	
13	APR 16, 2021	SJD	AS PER MECHANICAL REVISIONS	
12	JAN 29, 2021	SJD	AS PER CITY COMMENTS (STABLE BUILDING)	
11	DEC 22, 2020	LVF	AS PER REVISED EXTERIOR GRADING	
10	DEC 3, 2020	LVF	AS PER REVISED SITE PLAN	
NO.	DATE	BY	REVISIONS	
DESIGN	BB	CHK'D	SF	DATE Nov. 9, 20
DRAWN	SJD	CHK'D	SF	

APPROVALS

STAMP



S. LLEWELLYN & ASSOCIATES LIMITED
CONSULTING ENGINEERS

Tel. (905) 631-6978
www.sla.on.ca
email: info@sla.on.ca

3228 South Service Road, Suite #105 East Wing, Burlington, Ont., L7N 3H8

CLIENT

INVIZIJ ARCHITECTS Inc.
185 YOUNG STREET, HAMILTON

PROJECT NAME

INDWELL/ROYAL OAK DAIRY
REDEVELOPMENT
225 & 247 EAST AVE NORTH, HAMILTON
(DA-20-001)

TITLE

PHASE 3 PRELIMINARY GRADING
& EROSION CONTROL PLAN

PROJECT No.

19087

DRAWING No.

C104

SCALE

1: 200

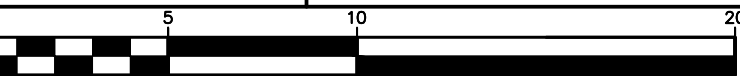

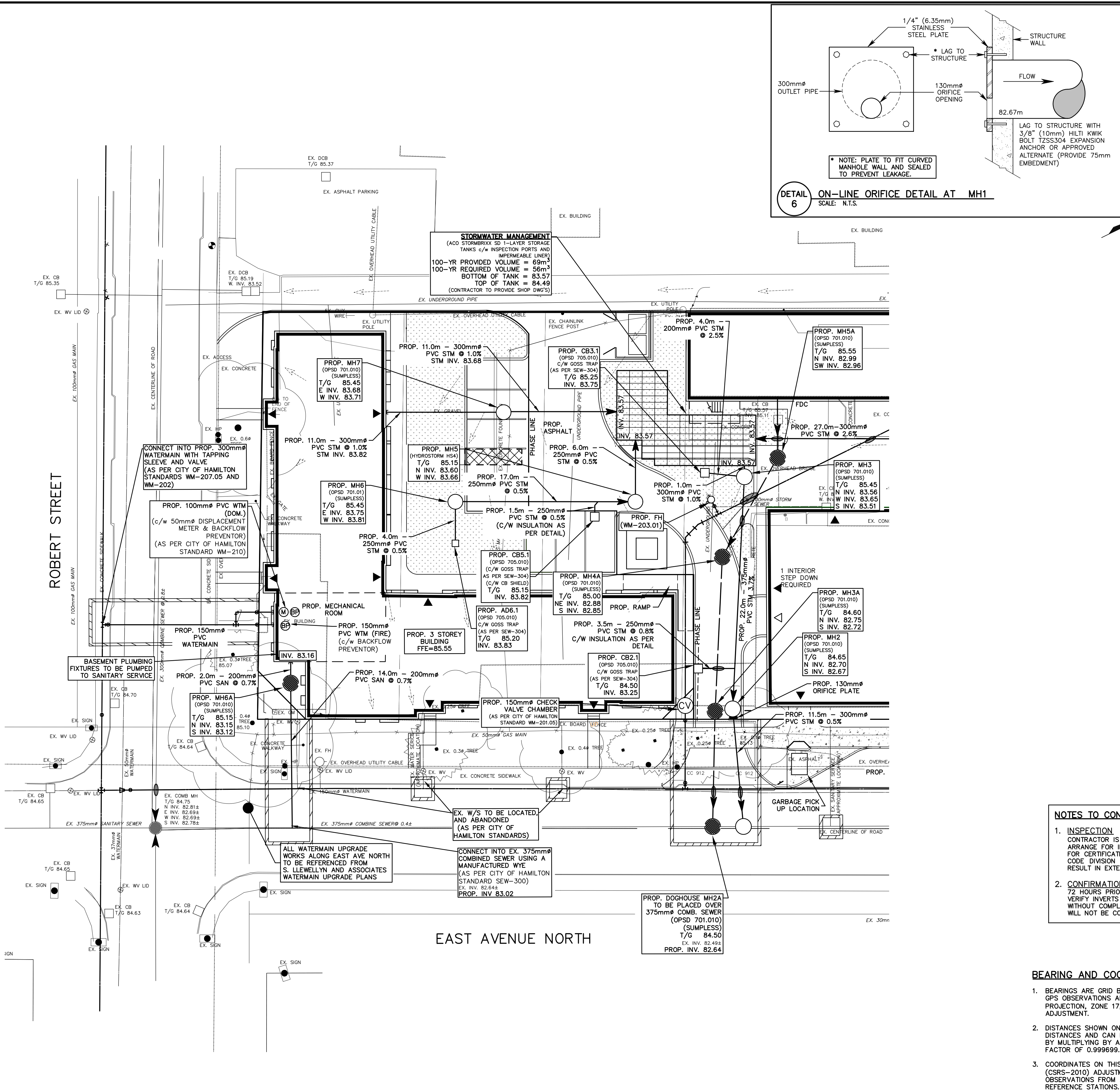

NOTES TO CONTRACTOR:				
1. CONTRACTORS AND SUBCONTRACTORS SHALL NOT SCALE FROM THIS DRAWING.				
2. ANY INCONSISTENCIES AND OMISSIONS FOUND ON THE DRAWINGS MUST BE REPORTED TO THE ENGINEER FOR CLARIFICATION BEFORE COMMENCING THE WORK.				
3. PRIOR TO THE START OF CONSTRUCTION, THE CONTRACTOR MUST CHECK AND VERIFY ALL DIMENSIONS AND ELEVATIONS AND REPORT ALL FINDINGS TO THE ENGINEER. ONCE CONSTRUCTION HAS COMMENCED, THE CONTRACTOR ACCEPTS RESPONSIBILITY FOR ALL DIMENSIONS, ELEVATIONS, AND SITE CONDITIONS.				
4. THE POSITIONS OF POLE LINES, CONDUITS, WATERMANS, SEWERS AND OTHER UNDERGROUND AND OVER-GROUND UTILITIES AND STRUCTURES ARE NOT NECESSARILY SHOWN ON THE DRAWINGS. WHERE SHOWN ON THE DRAWING, THE ACCURACY OF THE POSITION OF SUCH UTILITIES AND STRUCTURES IS NOT GUARANTEED. BEFORE STARTING WORK, THE CONTRACTOR SHALL INFORM THEMSELVES OF THE EXACT LOCATION OF ALL SUCH UTILITIES AND STRUCTURES AND ASSUME ALL LIABILITY FOR DAMAGE TO THEM.				
5. ALL DRAWINGS REMAIN THE PROPERTY OF THE ENGINEER AND SHALL NOT BE REPRODUCED, REUSED, OR REVISED WITHOUT THE WRITTEN CONSENT OF S. LLEWELLYN AND ASSOCIATES LIMITED.				

14	JUNE 7, 2021	SJD	AS PER REVISED SITE PLAN (PHASE 3)	
13	APR 16, 2021	SJD	AS PER MECHANICAL REVISIONS	
12	JAN 29, 2021	SJD	AS PER CITY COMMENTS (STABLE BUILDING)	
11	DEC 22, 2020	LVF	AS PER REVISED EXTERIOR GRADING	
10	DEC 3, 2020	LVF	AS PER REVISED SITE PLAN	
NO.	DATE	BY	REVISIONS	
DESIGN	BB	CHK'D	SF	DATE
DRAWN	SJD	CHK'D	SF	Nov. 9, 20

APPROVALS	
STAMP	

S. LLEWELLYN & ASSOCIATES LIMITED
CONSULTING ENGINEERS

Tel. (905) 631-6978
WWW.SLA.ON.CA
email: info@sla.on.ca

3228 South Service Road, Suite #105 East Wing, Burlington, Ont., L7N 3H8

CLIENT
INVIZIJ ARCHITECTS Inc.
185 YOUNG STREET, HAMILTON

PROJECT NAME
INDWELL/ROYAL OAK DAIRY
REDEVELOPMENT
225 & 247 EAST AVE NORTH, HAMILTON
(DA-20-001)

TITLE
PHASE 3 PRELIMINARY SITE
SERVICING PLAN

PROJECT No. 19087
DRAWING No. C105

SCALE 1:200